

web

YOGI VEMANA UNIVERSITY: KADAPA



Prof. D. Vijaya Raghava Prasad
Controller of Examinations

Phone: Off : 08562-225422
Mobile No: 9703216198
Fax : 08562-225419
Email: controllervemana@gmail.com

No.YVU/CE/Counter tables and Linear Table/ Recall for quotation /2018-19

Date: 23.01.2019

To
The Interested Firms,
Sir/Madam,

Sub: - YVU - Examination Branch – Supply and install of Counter tables 3 & 2 and Linear Table in the Examination Branch, Yogi Vemana University, Kadapa – Recall for Quotations – Request –Reg.

Ref: - Orders of the Vice-Chancellor dated: 26.12.2018.

I am to inform you that the following tables as mentioned below are required to supply and install as per enclosed technical drawings at various sections in the examination branch, Yogi Vemana University, Kadapa. Therefore, the firms are requested to send you lowest quotation in triplicate in a sealed cover directly to **The Registrar, Yogi Vemana University, Vemanapuram, Kadapa-516005, A.P.**, so as to reach on or before **11.02.2019** by Registered Post /Speed Post/Courier/Drop box. The details are furnished below.

S.No	Name of Items	Approx. Quantity	Specifications
01.	Counter Table: 3 seater Counter Table: 2 seater Supply and Install of L-shape Table Size – 1500/1500W x 900/750D x 1050Ht. Linear Table Size – 1500L x 900D x 1050Ht.	3 No's 5 No's	75 mm thick Slide Based partitions are considered with fabric above and laminate tiles below the table top. Soft tiles board shall be provide for each workstation. Raceway to be below table top and at the skirting for Electrical and Data wiring and to fix the switches on the metal raceways. Table top shall be made of 25mm thick pre- laminated particle board. The edges of the work surfaces will be sealed with PVC edge bending. The work surfaces shall be designed for fixing at 750mm from the ground level. The work surface support system has to be designed to adjust the height of the work surfaces by +/- 25 mm thus adding to user's ergonomic comfort. 25mm thick 900W x 450D pre- laminated particle board plank to be fitted on the Frame for linear workstation for Counter support of Books / Papers. Accessories 1. Pedestal 2. Keyboard tray 3. Hanging CPU Stand
02.	Linear Table: Supply and Install of 1. Table Size – 900L/ 750D x 1050 Ht. 2. Table Size – 1500L x 750D x 1050Ht.	35 No's 2 No's	Table top shall be made-up of 25mm thick pre-laminated particle board. The edges of the work surfaces shall be sealed with PVC edge bending. The work surfaces shall be designed for fixing at 750 mm from the ground level. The work surface support system has to be designed to adjust the height of the work surfaces by +/- 25 mm thus adding to user's ergonomic comfort. Privacy separator of 300 mm height above the table top for main and side span to be made of 8mm thick sandwich colour glass of approved make and shade with finish of all 4 corner to be radius and all edges to be grinded and polished. The

			screens to be mounted on the work surface by means of approved designed die cast studs. Desk base metal under structure to be made-up of MS pipe of 16 gauge thick of 50x50 mm square tube finished with approved colour powder coated with structural pipes for cross beams of 20x40mm tube to support table. Metal leg shall have plastic moulded cap and plastic moulded levelers to cater for floor undulations.
3	Hanging CPU-SLIM with adjustable height	32	Hanging CPU shall be made up of CRCA steel sections, Width (45-100 mm) shall be adjusted with safe load of 20 kgs, Height (310-530 mm) adjustment provision shall be available. The entire set finished with black powder coating.

Terms and Conditions

(Evidence shall be enclosed at the time of submission of quotation)

- (1) The above items shall be fitted at the office of the Controller of Examinations, Yogi Vemana University, Kadapa as per the ENCLOSED TECHNICAL DRAWING.
- (2) The firms has to include the Labor, installation charges and GST mentioned separately in quotation.
- (3) Quotation from Micro, Small and Medium Enterprises registered Manufactures (or) Authorized details across the country.
- (4) Product catalog if any along with the model matching with tender notice shall be marked in the quotation.
- (5) The firm shall bring a "model product" to meet the above specifications and explain the technical compliance to the central purchase committee at Yogi Vemana University, Kadapa upon intimation.
- (6) The firm shall have at-least 10 years of experience in manufacturing, supply and installation in the university/Institution.
- (7) 10% of the bill amount will be paid after one year of defect liability/guarantee period.
The Registrar, Yogi Vemana University reserves the right to accept/reject/cancel any or all the quotations without assigning any reason thereof.
- (8) The sealed quotation should invariably be super scribed as **No.YVU/CE/Counter tables 3 & 2 and Linear Table /2018-19, Due date 11.02.2019"** and send to **The Registrar, Yogi Vemana University, Vemanapuram, Kadapa - 516005.**

Thanking you,

Yours faithfully,

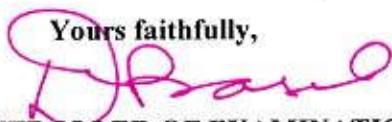
CONTROLLER OF EXAMINATIONS
CONTROLLER OF EXAMINATIONS
YOGI VEMANA UNIVERSITY
KADAPA - 516 003.

Encl: Technical Drawing

To

- Copy to the Web Committee, YVU to place in the University Website.
Copy to P.A to the Hon'ble Vice-Chancellor, YVU for favour of information.
Copy to file.

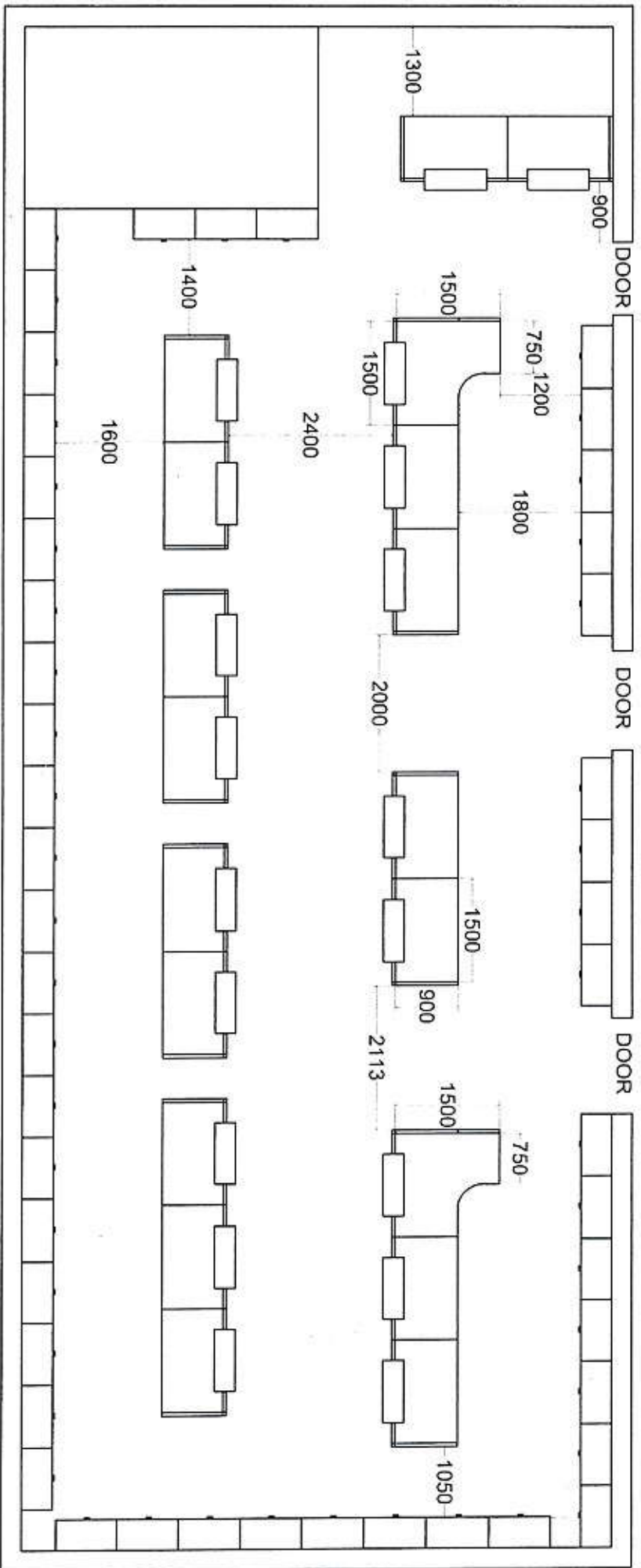

[Handwritten Signature]
 CONTROLLER OF EXAMINATIONS
 YOGI VEMANA UNIVERSITY
 KADAPA - 516 003.

19 SEATS

Prasad

CONTROLLER OF EXAMINATIONS
YOGI VEMANA UNIVERSITY
KADAPA - 516 003.

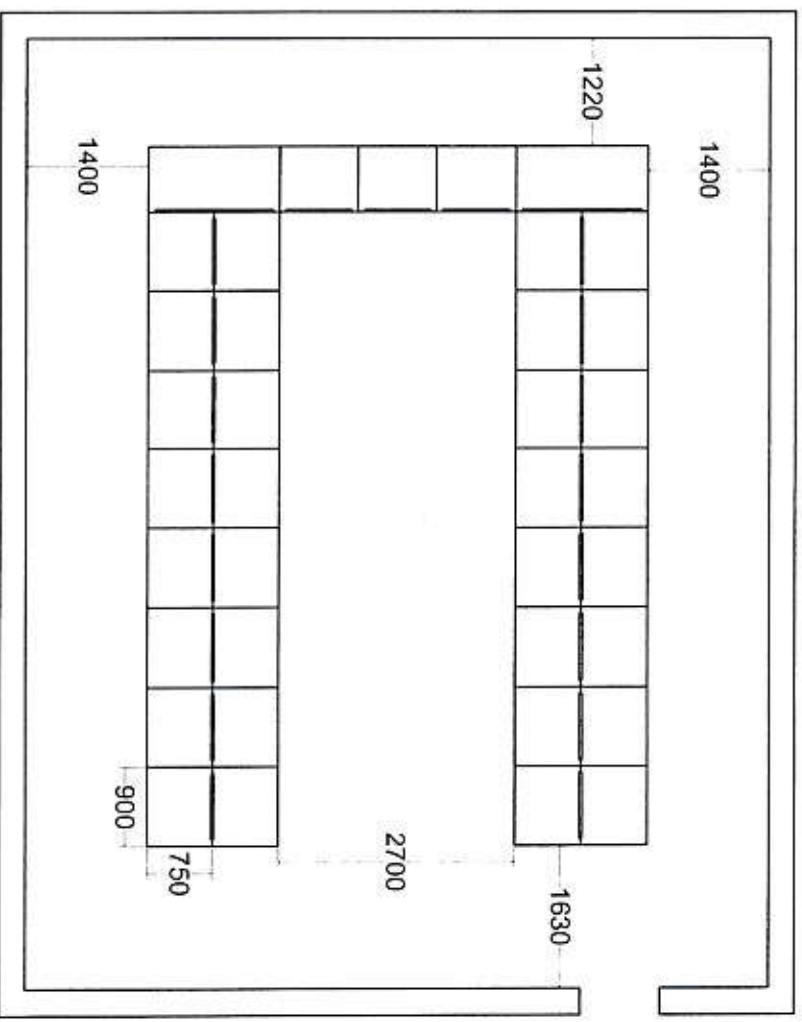

37 SEATS